



Main Features

- Pressure ranges: from 0...2 to 0...500 bar (0...30 to 0...7500psi) and pressure ranges from -1...+1 to -1...+10 bar
- Output signal 4...20mA 2-wires / 0,1...5,1Vdc / 0,1...10,1Vdc / 0...5Vdc / 0...10Vdc / 1...5Vdc / 1...10Vdc
- Protection level: IP65
- Material in contact: AISI 430 and 17-4PH

TKG transmitters are based on the thick film extensimetric (over 30 bar) and piezoresistive (up to 30 bar) measurement principle.

Thanks to highly stable electronic components, these transmitters can be used in applications requiring long-distance signal transmission or in smart control systems. TKG pressure transmitters were developed mainly for measuring pressures in the industrial refrigeration and air conditioning fields.

They are also used to monitor and control other mechanical installations.

TECHNICAL DATA

	VOLTAGE	CURRENT
Output signal		
Sensor class	H 0,3% FSO (1) M 0,6% FSO (1)	
Resolution	Infinite	
Measurement range	-1...+1 to -1...+10bar and 0...2 to 0...500bar (0...30 to 0...7500psi)	
Max. applicable pressure (without decay) (2)	2 times Full Scale	
Resistance to bursting	3 times Full Scale (max.1000bar / 14500psi)	
Power supply ± 5%	15 to 30Vdc	10 to 30Vdc
Max. input on power supply (3)	13mA	32mA
Isolation resistance at 50Vdc	>1000MΩ	
Rated pressure signal: FS H = ± 0,5% M = ± 1%	B 5,1 Vdc C 10,1 Vdc M/P 5 Vdc N/Q 10 Vdc	E 20mA
Ambient pressure signal: FS H = ± 0,5% M = ± 1%	B/C 0,1 Vdc M/N 0 Vdc P/Q 1 Vdc	E 4mA
Max. allowed load	1mA	see diagram
Max. response time (10...90% FSO)	Range ≤ 30bar 1 msec. Range > 30bar 4 msec	Range ≤ 30bar 1 msec Range > 30bar 8 msec
Output noise (RMS 10-400 Hz)	< 0,05% FS	
Output short circuit protection and reverse power polarity	YES	
Output pulse overvoltage protection	YES	NO
Compensated temperature range	-10 to +70°C (+14 to 158°F)	
Permitted temperature range	-20°C to +80°C (-4 to 176°F)	
Storage temperature range	-30°C to +85°C (-22 to 185°F)	
Thermal drift in compensated range (zero - sens.)	<0,02% FSO/°C (<0,01% FSO/°F)	
Materials in contact with measurement fluid	> 30bar AISI430 and 17- 4 PH ≤ 30bar AISI304 and AISI316	
Outer case materials	AISI 304 stainless steel Nylon 66GF35VO	
Protection level	IP65	
Process connections	G 1/4" male, G 1/2" male, G 1/4" female	
Electrical connections	mod. F 2-4 pole shielded cable mod. M 4-pole connector DIN43650A-ISO4400 mod. V 6-pole connector VPT02A-10-6PT2	

FSO = Full scale output (output signal at rated pressure)
1 BFSL (Best Fit Straight Line) method
2 tested for more than 1000 strokes with single duration < 2msec.
3 with 30V power supply, max. load calibration signal on.

MECHANICAL DIMENSIONS

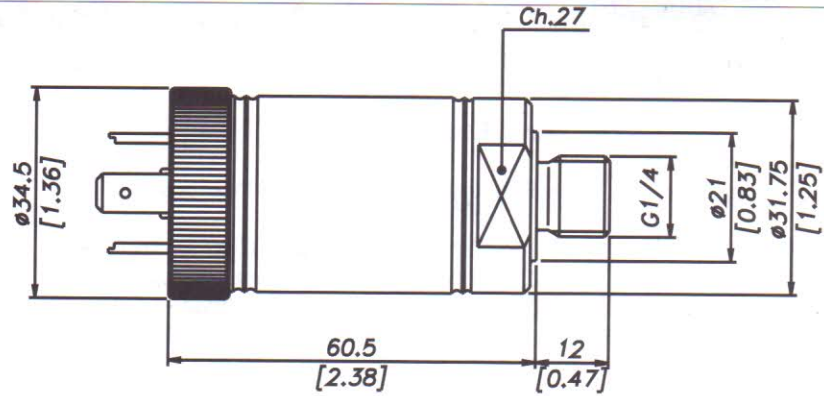

1/4" G male
connection
(code 1)

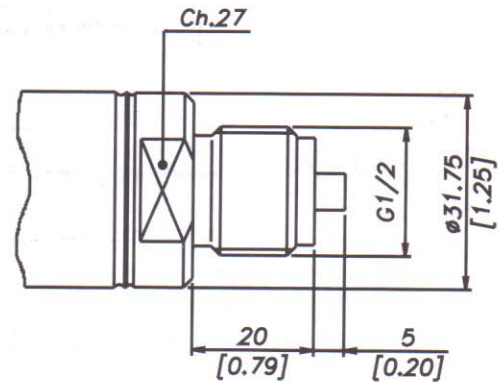

1/2" G male
connection
(code 3)

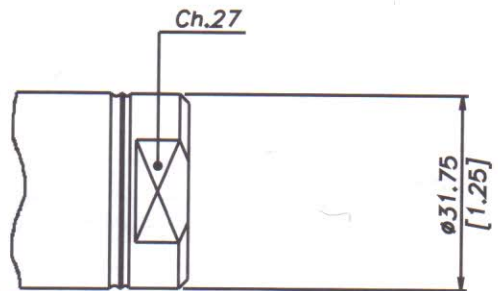

1/4" G female
connector
(code 4)

ATTENTION: For installation, use a maximum locking torque of 20Nm.

ADAPTERS AVAILABLE ON REQUEST

From 1/4G female to 1/4G male	PKIT101	From 1/4G female to M12x1,5 male	PKIT106
From 1/4G female to 1/8-27 NPT male	PKIT102	From 1/4G female to 7/16-20 UNF male	PKIT107
From 1/4G female to 1/8-27 NPT female	PKIT103	From 1/4G female to 1/2G male	PKIT108
From 1/4G female to M14x1,5 male	PKIT104	From 1/4G female to 1/4-18 NPT female	PKIT109
From 1/4G female to 1/4-18 NPT male	PKIT105	From 1/4G female to 7/16-20 UNF female	PKIT111

MECHANICAL DIMENSIONS - Connectors

